

TEN PIN FLEX LANES

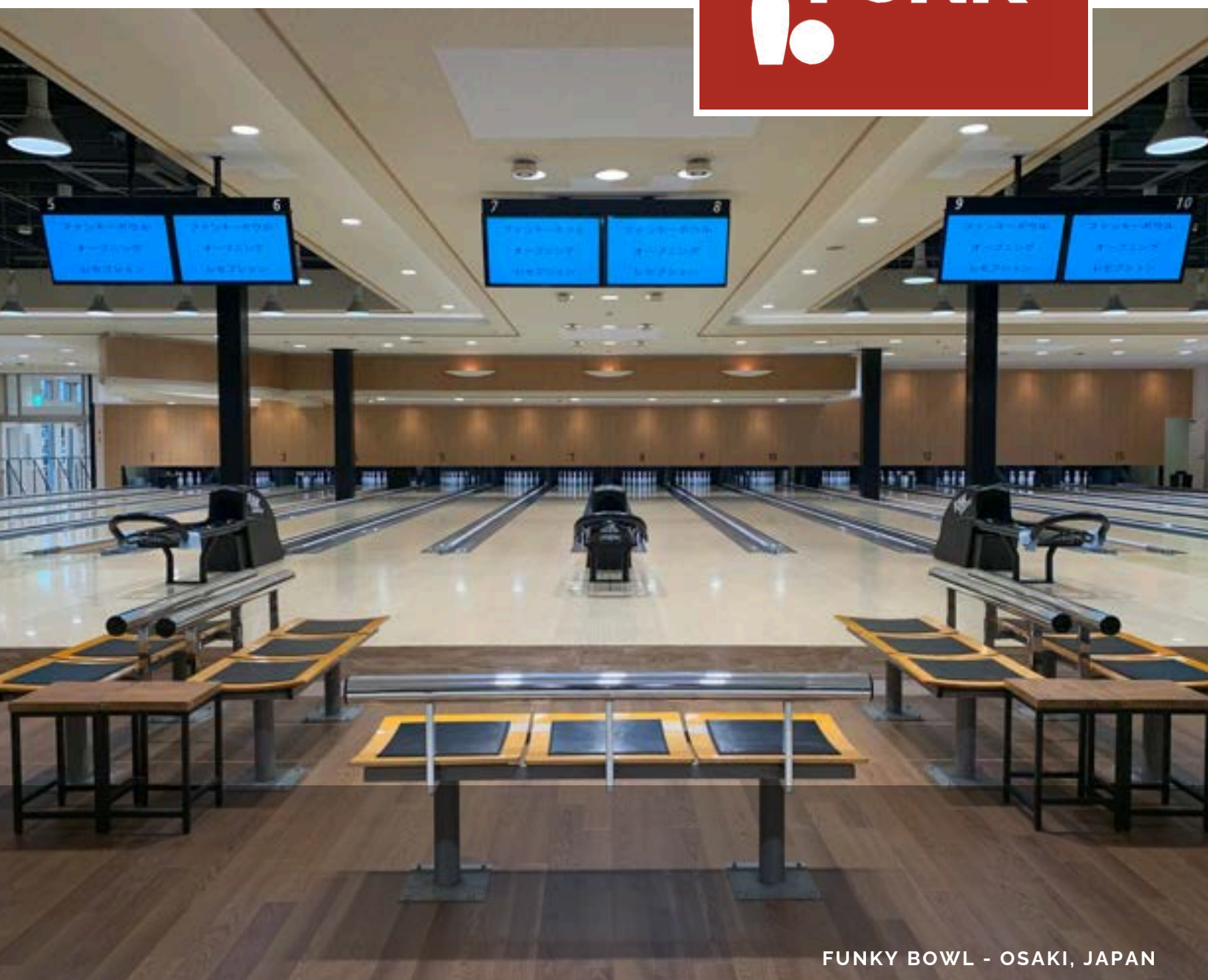

FUNKY BOWL - OSAKI, JAPAN

www.funkbowling.com

WELCOME TO THE **FUNK** FAMILY

We at Funk value our clients and as a warm thank you for reaching out we'd like to assure you that as a family-owned and operated business with over 130 years of bowling expertise, your endeavors rest in great hands!

To further cement how much your business means to us, here is a personalized welcome from the man himself!

*Thank you for your
business and your trust.
It is our pleasure to work
with you.*

-Karl Funk Jr.





BOWLING ALLEYS

We've been helping bowling alleys run more profitable businesses for decades by minimizing equipment downtime and maintenance costs. We offer turnkey bowling alley installations from the ground up or we can help you upgrade your existing lanes. We offer customized project packages for our bowling alley partners that can range from an entire bowling alley design and installation to equipment upgrades and aesthetic makeovers.



ENTERTAINMENT CENTERS

Bowling is no longer limited to the traditional bowling alley. We have worked with a number of "entertainment centers" to bring the most engaging bowling experiences to a customer base that is looking for fun and excitement. We'll work with your facility team to incorporate the right kind of bowling experience for your space and your customers.



IN-HOME BOWLING

We own every possible bowling alley production step allowing us to offer the most exclusive, personalized alley installations that fit your needs. Looking for a couple bowling lanes that you can enjoy in the comfort of your own home? We offer end-to-end lane design and engineering to fit your home's unique layout while also offering you the ability to customize it in a way that matches your home's aesthetics.



BARS & HOTELS

Looking to differentiate your bar or hotel? We've installed full size lanes as well as mini-bowling alleys into a variety of bars and hotels. These can help transform the experience of your establishment offering a unique entertainment element for your customers.



OUR HI

1960 FIRST AUTOMATED STRING PINSETTER

Founder Karl Funk worked as an electrician for a bowling company that was developing the first advanced automated string pinsetter.

1964 FUNK BOWLING FOUNDED

Founder Karl Funk decides to move forward as an independent bowling manufacturer. Only 22 years old and nothing but an ambitious vision, Karl Funk founded Funk Bowling.

1972 ACQUISITION OF KRÖLL

The automated string pinsetter was highly successful, leading to the acquisition of Germany's oldest bowling company, Kröll.

1985 ACQUISITION OF SPELLMANN

Karl Funk bought Spellmann, the largest German 9-Pin bowling manufacturer. The newly formed company group included over 200 employees and quickly became the largest bowling manufacturer in Europe.

2000 2ND PRODUCTION FACILITY BUILT

Funk builds a brand new production facility in the south of Germany. As a result, Funk became internationally known and now exports its products all over the world.

2003 FUNK 2ND GENERATION JOINS COMPANY

The second generation, Karl-Heinz Funk, joined the company to further develop their international presence.



STORY

2009 FUNK'S FIRST STEPS ON US SOIL
Hall of Fame Bowling Head Coach Bill Straub and the Nebraska Cornhuskers Bowling Team adopt Funk string pinsetter technology in their state-of-the-art practice facility. The Cornhuskers have won 3 NCAA championships since.

2018 FUNK NORTH AMERICA FOUNDED
The 3rd generation, Alexander Funk, joined the family business in 2018, further accelerating international growth with the foundation of Funk North America in Detroit, MI.

2022 FUNK SOFTWARE FOUNDED
By following the Funk-Credo of continuous innovation, the focus on software solutions of the future is further emphasized with the foundation of another entity for the company group.

2023 USBC APPROVES STRING PINSETTER
Funk's legacy product, the String Pinsetter, has finally been certified by the worlds largest governing body, USBC. Funk has led the technological advancement of this technology for 60+ years and is proud of the industry-wide adoption of String Pinsetter technology.

2023 FUNK JAPAN FOUNDED
The successful completion of Japan's first String Pinsetter center in 2022 has sparked great interest among the proprietors in one of the largest domestic bowling markets in the world. The successful String Pinsetter certification by the BPJ in 2022 has paved the way for another expansion to the Funk Company Group: Funk Japan Ltd.



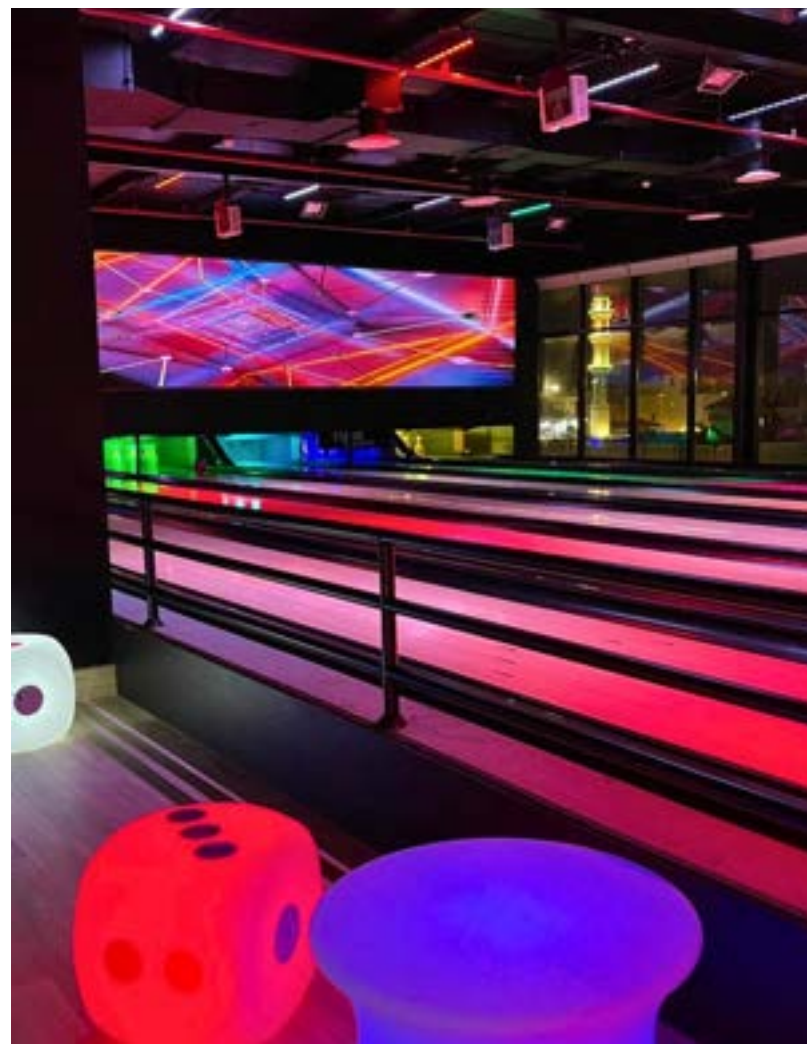

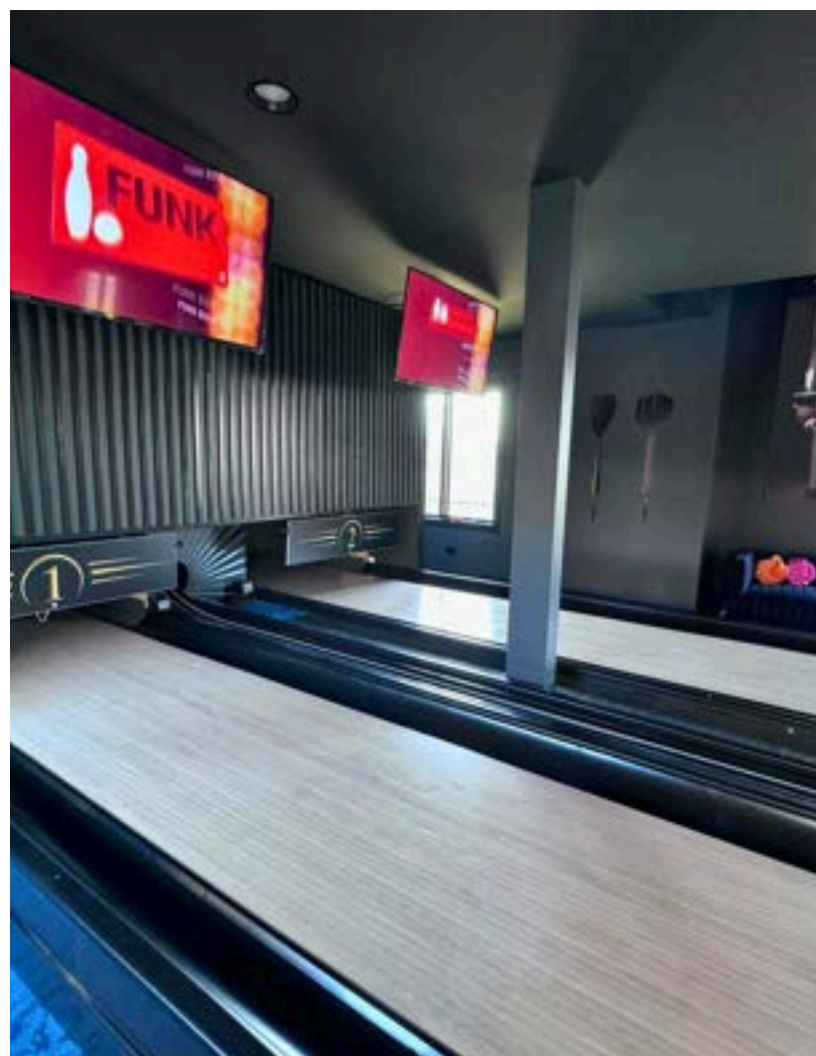



FUNK TENPIN FLEX LANES

SPECIFICATIONS



FLEX Tenpin Specifications

Standard length of lane which is the foul line to the back of the pin deck is 63' (1920cm) 4' (122cm) of that is the pin deck

Standard approach is 15-16' (457-488cm)

There is also length needed in addition to lane for pinsetter and this space depends on the pinsetter Funk String Machines require an additional 5' 3" (160cm)

Total Standard length for a complete lane with approach using a Funk String Pinsetter (using the higher numbers) is 84' 3" (2568cm) plus seating area if applicable

Recommended seating area: 12-15' (366-457cm)

All of these measurements are standard but everything is customizable.

Power Requirements

Power: 208/220v

Current Draw: 11.7 amps

Recommended Circuit: 220v, 20 amp single phase

Suggested receptacle/plug: 20 AMP, 120 / 250 Volt, L14-20R/20P

Scoring Power: 110v Quad outlet isolated ground

Recommended Circuit: 110v, 20 amp



Number of Lanes	Underground return		Above Ground return	
	Width Inches	Width Centimeters	Width Inches	Width Centimeters
1	6' 3"	160	6' 6-1/2"	169
2	11' 4"	345	11' 7-1/2"	354
4	22' 5-1/4"	684	23' 1/4"	702
6	33' 6-1/2"	1022	34' 5"	1049
8	44' 7-3/4"	1361	45' 9-3/4"	1397
10	55' 9"	1699	57' 2-1/2"	1744
12	66' 10-1/4"	2038	68' 7-1/2"	2092
14	77' 11-1/2"	2376	80'	2439
16	89' 3/4"	2715	91' 4-3/4"	2787
18	100' 2"	3053	102' 9-1/2"	3134
20	111' 3-1/4"	3392	114' 2-1/4"	3482
22	122' 4-1/2"	3730	125' 7"	3829
24	133' 5-3/4"	4068	136' 11-3/4"	4176
26	144' 7"	4407	148' 4-1/2"	4524
28	155' 8-1/4"	4745	159' 9-1/4"	4871
30	166' 9-1/2"	5084	171' 2"	5219
32	177' 10-3/4"	5422	182' 6-3/4"	5566
34	189'	5761	193' 11-1/2"	5914
36	200' 1-1/4"	6099	205' 4-1/4"	6261
38	211' 2-1/2"	6438	216' 9"	6609
40	222' 3-3/4"	6776	228' 1-3/4"	6956

TENPIN FLEX LANES

SPECIFICATIONS

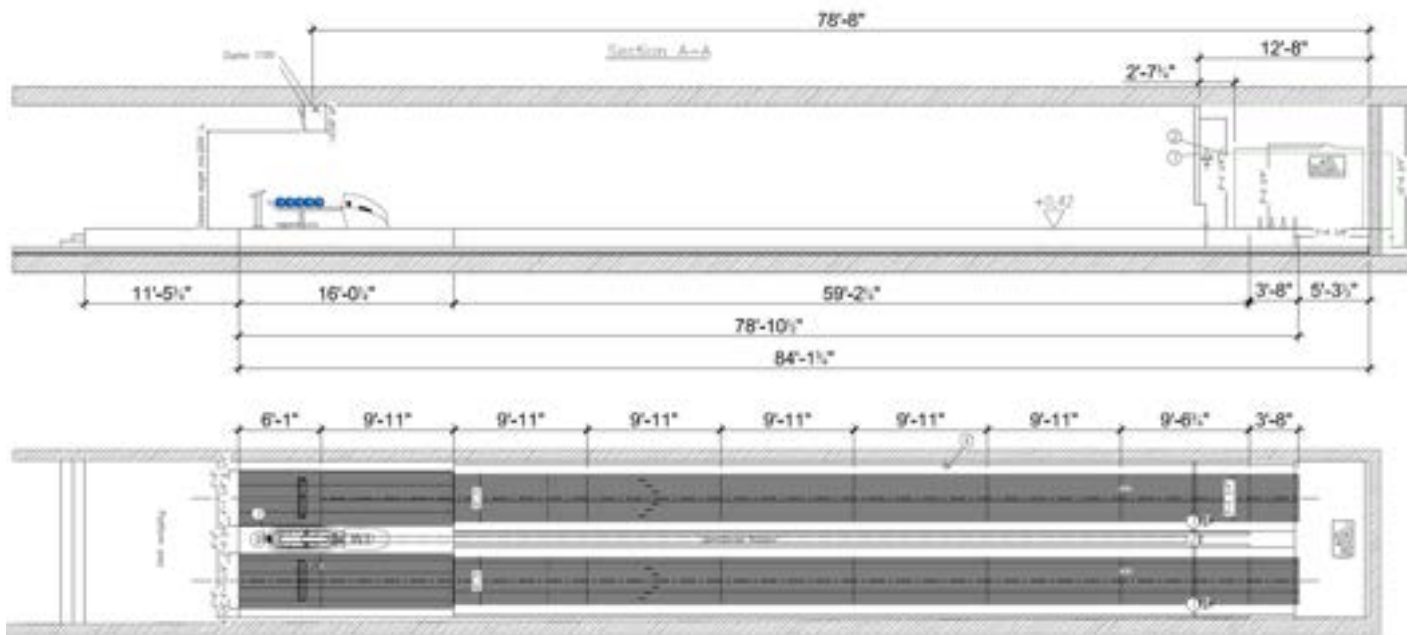

Possibilities of the flex lane

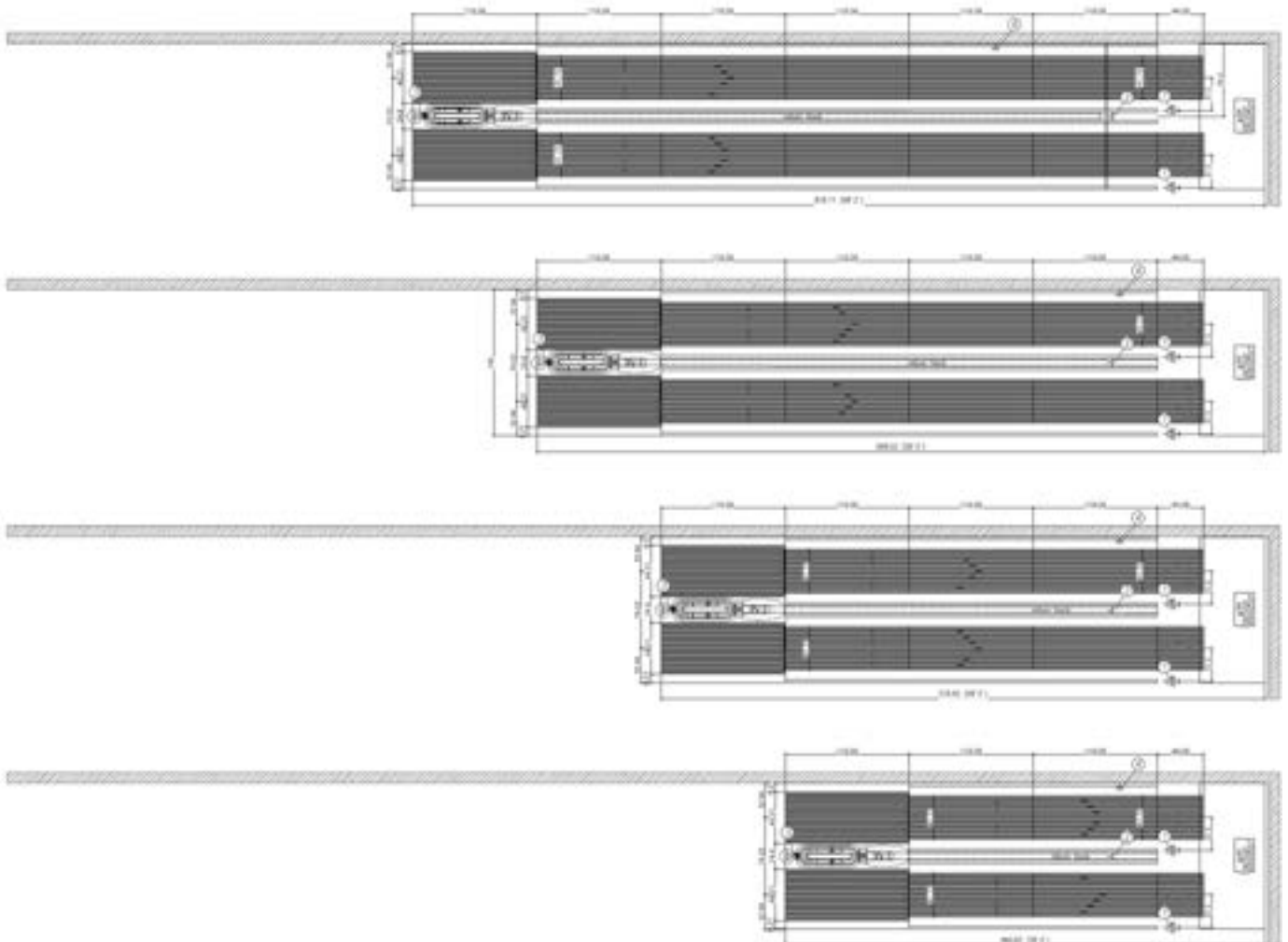

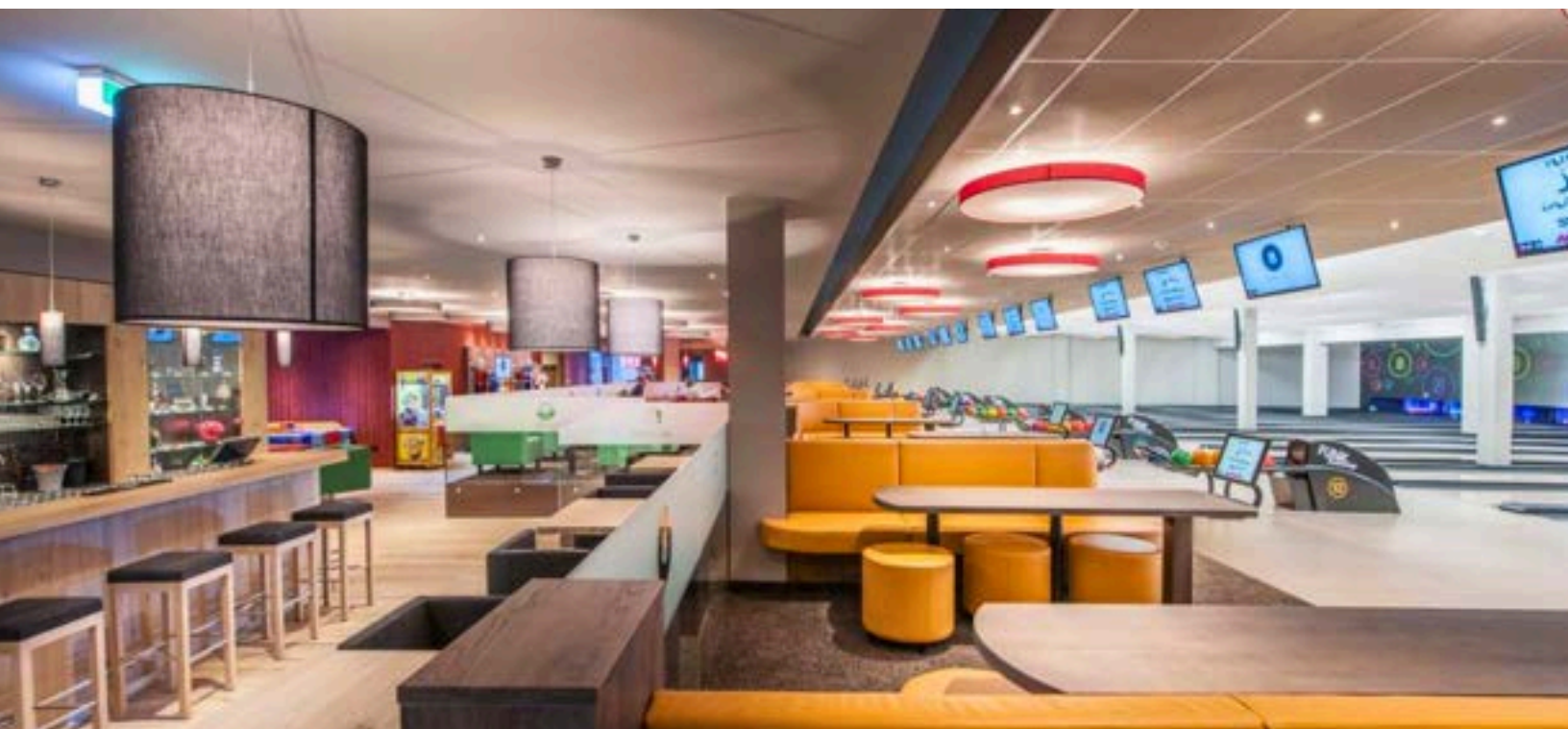

Funk North America Inc.
35476 Mound Rd.
Sterling Heights, MI 48310

Phone: (586)553-9969
eMail info@funkbowling.com

 [funk.bowling](https://www.instagram.com/funk.bowling)



 [FUNK Bowling](https://www.facebook.com/FUNK.Bowling)

Karl Funk GmbH & Co. KG
An der Schnellstraße 6
DE 88437 Maselheim-Äpfingen, Germany

Telefon +49 (0) 7356 / 9370-0
eMail info@funk-bowling.de

 [FUNK Bowling](https://www.youtube.com/FUNK.Bowling)